

Installation instruction A-symmetric Downlighter

General instruction

Read this instruction carefully and after installation save the instruction for future references and maintenance.

Safety

- Before installation, maintenance or changing the lamp, the electricity to the source of light has to be switched off.
- For installation of the luminaires a qualified electric engineer is recommended. He has to install the luminaire in compliance with the most recent stipulations and installation instructions.
- Check the total capacity of the actual current circuit, this may not exceed the maximum allowed capacity of the section.
- To prevent heating up, the luminaires should not be covered, e.g. by isolation covers or blankets.
- All replacement parts must be equal to the original parts.

Product specification

- This first class luminaire has to be earthed.
- IP20 classified, unless mentioned otherwise. To be used for inside a building.
- To be used on surfaces with normal risk of fire.
- 230/240V AC 50Hz.
- It is recommended that the surrounding temperature is less than 25° C.
- CE marked.
- This product is designed and produced in compliance with stipulations of: EN55015; EN 60592-2; EN 60598-2-2.

Installation

- In the ceiling a hole (diameter 245 mm.) has to be made, corresponding to the hole measures of the luminaire used (1).
- Push the luminaire into the hole and fix it with the installation grips, these have to be moved into the ceiling. The luminaire is fixed now (2+3).
- Place the lamp. The lamp used, has to be of a type and power corresponding to the label given inside the luminaire (4). We recommend you to use an A-type brand lamp.
- Connect the luminaire with the actual electric current circuit. Switch on the current, check correct operation.

Lamp type

Inside is a label which lamp type you should use, if applicable.

Do NOT diverge!

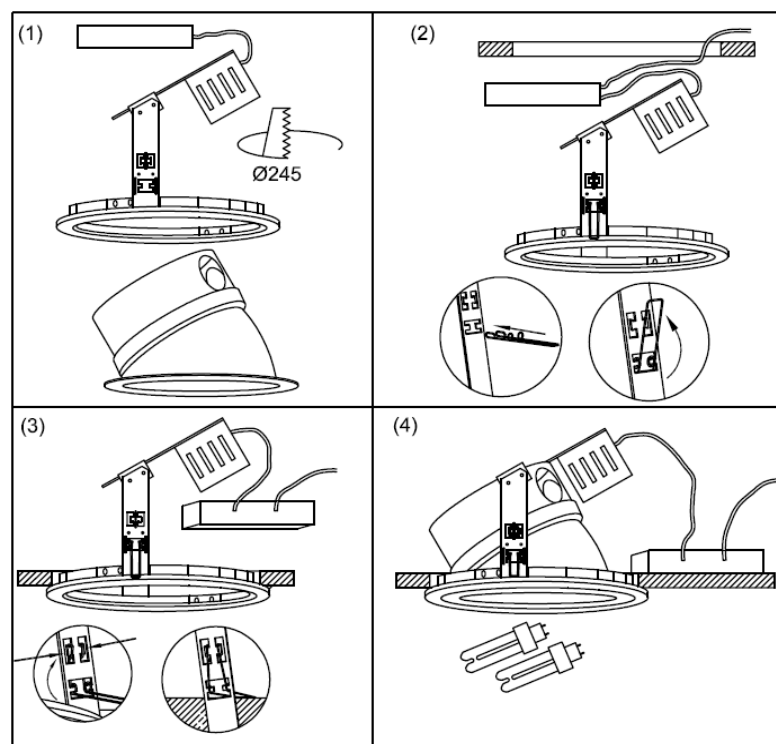

To guarantee the dependability and correct working, the installation instruction must be followed up correctly. Changes are not allowed. When changes are made on the luminaires, the warranty will expire. Emilux B.V. does not take any responsibility when luminaires are modified in any way!

